

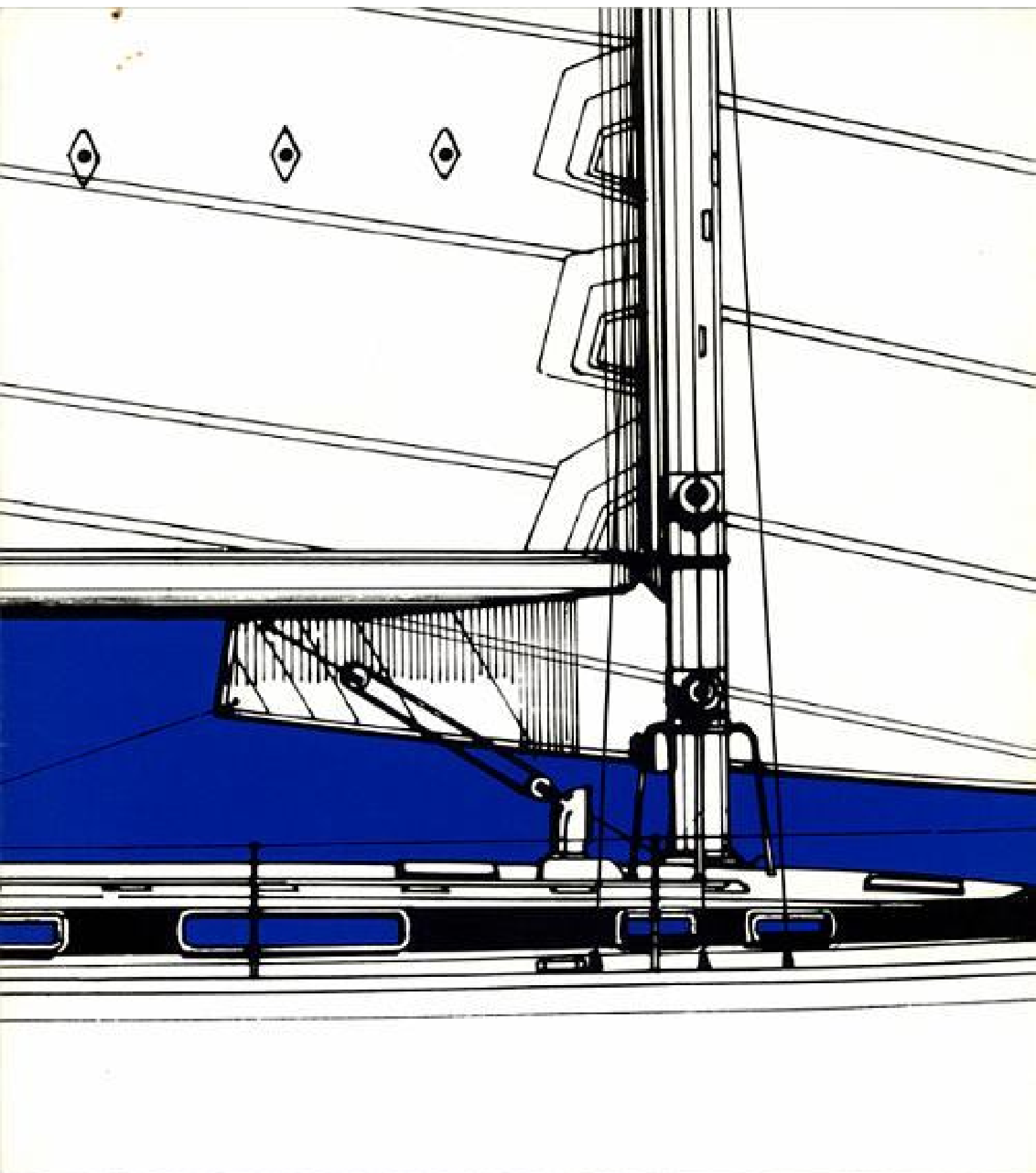

MOORINGS 51



 THE MOORINGS 51

SPECIFICATIONS AND EQUIPMENT

PROPULSION & STEERING

- Fresh water cooled 85 HP Perkins diesel engine (4-236) with Hurth HW 360 transmission
- 90 Amp alternator
- Foam insulated engine compartment
- Three blade bronze propeller
- Stainless steel propeller shaft
- Recessed engine instrument panel in cockpit convenient to helm
- Stainless steel fuel tanks with gauge
- Oil transfer pump
- Manual engine stop
- Alarm system for engine oil pressure and water temperature
- Raycor fuel filter
- Pedestal steering with single lever engine controls
- Pedestal brake
- Sheave and cable steering (Good)
- 5" compass with binnacle
- Stainless steel destroyer wheel with leather cover
- Emergency tiller

DECK HARDWARE

- Vertical drum electric anchor windlass
- Self bailing divided anchor locker for rode with 2 mooring cleats

- Vinyl coated stainless steel double lifelines and stainless steel profiled stanchions
- Welded stainless steel bow pulpit with running lights and halyard loops
- Anchor well
- Cockpit light
- Welded stainless steel opening pushpit with bracket for horseshoe buoy and teak flagpole
- New design toe rail to minimize chafe
- Separate deck fill & vent for each water tank

- Six opening tinted aluminum Goyot hatches 485cm x 485cm
- One Goyot aluminum tinted hatch 650cm x 650cm
- One sliding hatch
- One-part hatch board with vents
- Two winch handle storage

PLUMBING

- Four Bridon ITT marine toilets
- Ball valve shut-off for each head
- Fresh water deck shower
- Manual back-up water pump in galley

- Raritan 12 gal hot water heater
- Four 12 volt shower sump pumps, Par ITT
- Bronze seatcocks on all thru



Looking forward in the main saloon at the helm (forward staterooms (their aft bulkheads removed) in this illustration).

- Welded stainless steel safety rack around mast
- 2 bow and 2 stern mooring cleats
- Spring line cleats
- Double stainless steel bow fitted anchor roller for 45 lb CQR and 33 lb Bruce
- Port and starboard lifeline gates
- Aluminum genoa tracks port and starboard with cars
- Adjustable Goyot mainsheet traveler, Lewmar #43 mainsheet self-tailing 2-speed winch and cleat
- Two #65 Lewmar self-tailing, two speed genoa winches and cleats
- Anodized aluminum thru-bolted toe rail with six fairleads
- Two winch handles
- Teak grabrails, slatted seating in cockpit, cockpit grate
- Cockpit table with built-in icebox
- Thirteen opening Goyot aluminum ports

- hulls below waterline
- Ball valves on all thru hulls above water line
- Complete polypropylene fresh water plumbing system
- Pressure hot and cold water system (heavy duty Par pumps)
- Manual bilge pump



Portside in main saloon, showing dining area, entrance to both portside heads and a small part of the aft stateroom.

- Standard fleetless specification
- Special Moorings specification



During April 1985, the first of a fleet of Moorings 51's will begin arriving. They represent the very latest thinking of both Charlie Cary and German Frers, the 51's brilliant designer. These new 51's fill the void produced by our phasing out of our fleet of Gulfstar 50's and are an exciting improvement in every respect.

Their shape is similar to the Moorings 43, stretched out to a longer and leaner looking hull. As Moorings was the first to bring center-cockpits into Caribbean charter, some will be surprised to see the large aft-cockpit on this 51. The size and volume of our hull allows the 51 to provide an elegant aft-stateroom without the compromises center-cockpit arrangements inevitably entail. And sailors have always preferred to sit, steer and party aft.

Below, the Moorings 51 offers three equal and private staterooms, each with its own head and shower, an outstanding galley and main saloon, and a private crew cabin with its own head and shower. So, here's a layout that works for bareboating as well as crewed charters—all in a hullshape with an excellent pedigree for performance.

Moorings 51's are built by Beneteau to the specifications we developed expressly for charterwork. We are very confident that this will become the new standard for the industry and a most popular design.

PARTIAL SPECIFICATIONS

Length Overall	50' 10"
Waterline Length	58' 9"
Beam	14' 8"
Draft	6' 0"
Ballast	13,000 lbs.
Displacement	33,500 lbs.
Sail Area (120% genoa)	1,028 sq. ft.
I	58' 0"
J	20' 8"
P	51' 10"
E	18' 8"
Water Capacity	370 gallons
Fuel Capacity	132 gallons
Engin.	Perkins 4 - 236 @ 65 Hp.

- Three 12 volt automatic electric bilge pumps
- Four fresh water tanks GRP total 375 gals
- Sherwood water strainers

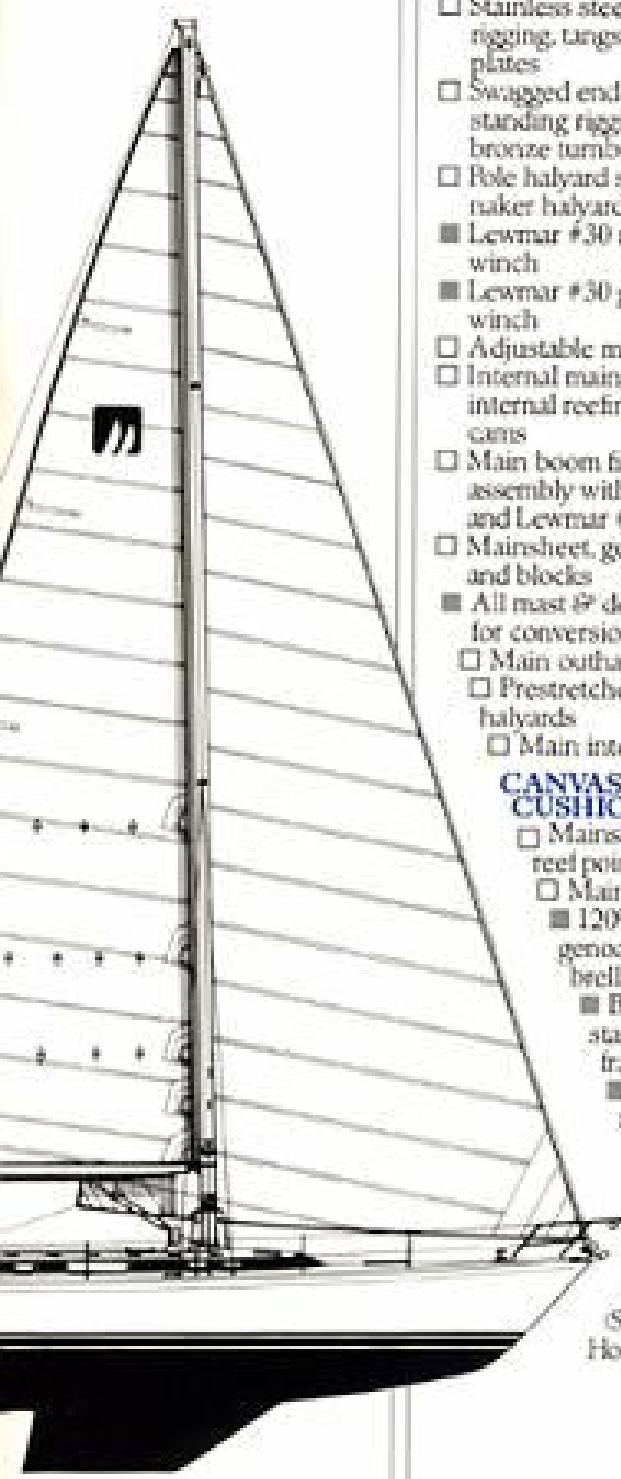

SPARS & RIGGING

- Sloop rig
- Anodized aluminum keel stepped mast and boom, double spreaders, internal halyards, cleats
- Giot roller furling genoa system
- Stainless steel standing rigging, tangs and chain plates
- Swagged end fittings on all standing rigging, chrome bronze turnbuckles
- Pole halyard sheave, spinnaker halyard sheave
- Lewmar #30 main halyard winch
- Lewmar #30 genoa halyard winch
- Adjustable main topping lift
- Internal mainsail outhaul internal reefing line with cars
- Main boom fixed gooseneck assembly with slab reefing and Lewmar #16 winch
- Mainsheet, genoa sheets and blocks
- All mast 1/2" deck hardware for conversion to cutter rig
- Main outhaul and blocks
- Prestretched rope halyards
- Main internal sail slot

CANVAS & CUSHIONS

- Mainsail with two reef points/slab reefing
- Mainsail cover
- 120% roller furling genoa with sun-brella protection
- Bimini top with stainless steel frame
- Closed-cell foam cockpit cushions

ELECTRONICS

- VHF radio/telephone (Standard Horizon USA)

- 12-volt AM/FM stereo cassette player with two speakers
- Depth sounder (Datamarine S-200)

HULL & DECK

- Molded fiberglass hull and fiberglass balsa-core reinforced deck
- Molded structural ribbed pan in hull
- Molded non-skid deck
- One Sail locker in cockpit
- Molded fiberglass cockpit seat hatch
- Propane storage compartment
- Molded fiberglass helmman seat
- Winch handle box in cockpit
- Three coats epoxy primer/sealer
- Anti-fouling bottom paint
- Boot top
- Opening transom with fold-down stainless steel swim ladder
- Self bailing cockpit

ELECTRICAL SYSTEM

- 120 volt, 30 amp retractable shore power cable
- Control panel with circuit breakers for 12-volt DC
- Four heavy duty 120 amp hours-marine batteries
- Automatic battery charger
- 12-volt engine room blower
- Battery parallel switch
- Radio ground cable attached to ballast
- Navigation lights
- Mast-head tri-color
- Combination bow and deck light
- Fluorescent light in saloon, heads, galley, staterooms
- Light for navigation area and chart area

- Statutory running lights
- Ammeter
- Six cabin fans

INTERIOR CONCEPT

- Varnished teak and holly cabin sole throughout

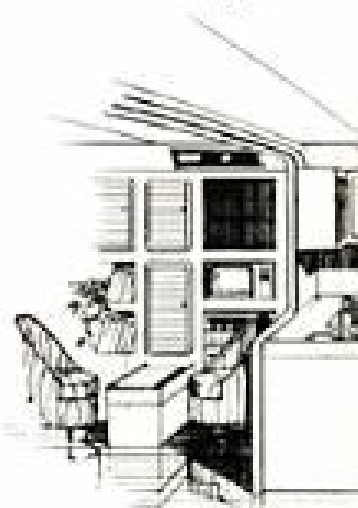

Galley and the small seating arrangement to starboard, aft in the main salon.

- Varnished interior teak or mica bulkheads and trim frames. Rounded bulkhead corners
- Vinyl upholstery 4" breathable foam cushions throughout
- White vinyl headliner, fire and mildew resistant

AFT STATEROOM

- Full double berth



Forward, starboard side in main salon, showing navigation station, door to head and small part of starboard stateroom.

- Lateral storage under cockpit
- Hanging locker
- Locker under berths
- Seat with drawers
- Three Gaisot opening port-holes

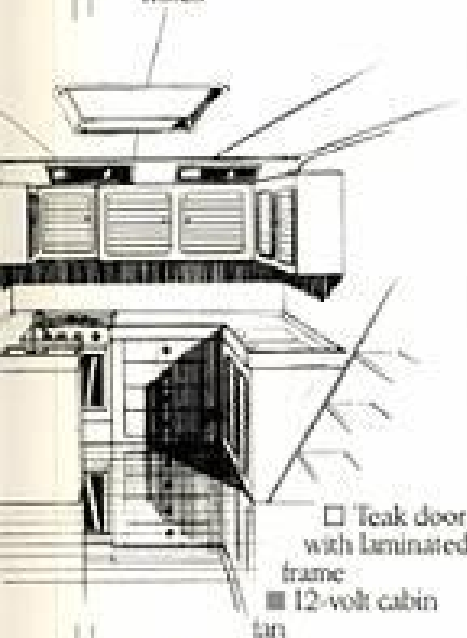

- Teak door with laminated frame
- 12-volt cabin fan

SALOON

- Port settee convertible to queen berth
- Folding table with bottle storage
- Grabrails
- Bookracks
- Two Cabin fans
- Teak coffee table with two revolving easy chairs

NAVIGATION STATION

- Large navigation station with revolving easy chair
- Book rack, locker, electronic storage
- Engine, electric indicator panels

GALLEY

- Frigo-refrigeration built into compartmented top-loading refrigerator/freezer (12 cu. ft. of useable capacity) minimum four-inch insulation, vapor barrier and pump-out capacity
- Gimballed 3-burner stainless steel propane stove and oven, stainless steel guard rail, solenoid shutoff and two aluminum fuel tanks

- Double stainless steel galley sinks with hot and cold pressure water
- Dish lockers, cupboards, utensil drawers
- Formica work surfaces with teak biddles

HEADS

- Four heads, integrated with each cabin
- Marine head
- Washbasin, pressurized water, hanging locker, storage locker, shower, teak shower grate, cabinet mirror
- Spring-loaded faucets

FORWARD STATEROOMS

- Full double berth
- Bench seat with drawers
- Hanging locker
- Storage
- Cabin fan
- Extra sound insulation in both surrounding bulkheads

CREWS QUARTERS

- Two single berths
- Private head & shower
- Hanging locker
- Storage

MOORINGS SPECIAL CRUISING GEAR

- Anchors:
 - 45 lb CQR with 18' of 3/8" galvanized chain and 250' of 5/8" nylon line
 - 33 lb BRUCE anchor with 12' of 3/8" galvanized chain and 150' of 5/8" nylon line
- Stainless steel barbecue grill with stern mount
- Binoculars - 7 x 50
- Blankets and pillows (8 each)
- Boat hook
- Bucket, brush, sponges
- Buoyant Cushions (2)
- Chafe gear for lines & shrouds
- Clothes hangers/plastic

- Dinnerware, flatware and glasses (service for 8)
- Deck lines (4)
- Fenders (3)
- Fire extinguishers (3)
- First Aid Kit
- Flag, courtesy (BVI, or St. Lucia)
- Flag U.S.
- Flares/emergency
- Flashlights (2) w/extra batteries
- Foul weather gear (2 suits)
- Fuel funnels (2)
- Galley equipment (pots, pans, utensils, etc.)
- Head hardware (towel racks, paper holder, mirror, etc.)
- One galvanized horn/signal, manual
- One pressurized horn/signal
- Horseshoe ring buoy & bracket
- Ice Bag
- Knife/riggers
- Lead line and lead
- Life preservers (8)
- Moorings Yacht operation manual
- Navigation equipment (divider, parallel rule, charts, pencils)
- Sail ties
- Sail repair kit
- Snorkeling equipment (masks, fins, snorkels)
- Tape, plastic & electric
- Tool kit, spare fuses, bulbs, oil, etc.
- Trash container
- Waste baskets (2)
- Yachtsmens Guide

*Details and specifications are subject to change without prior notice as the company and builder reserve the right to modify or improve the product. Illustrations may indicate non-standard items or personal effects.
© 1985 The Moorings, Ltd.*

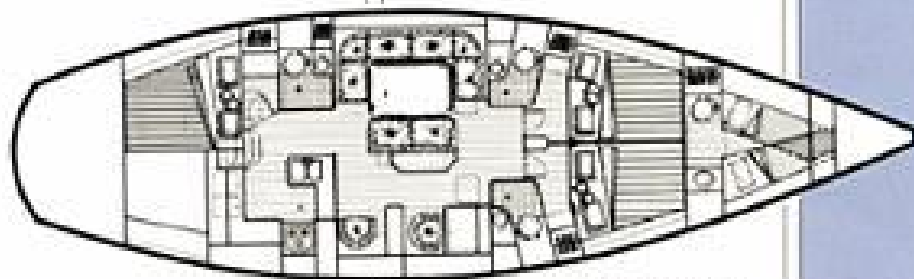

Printed in U.S.A.