

THE PASSPORT 40

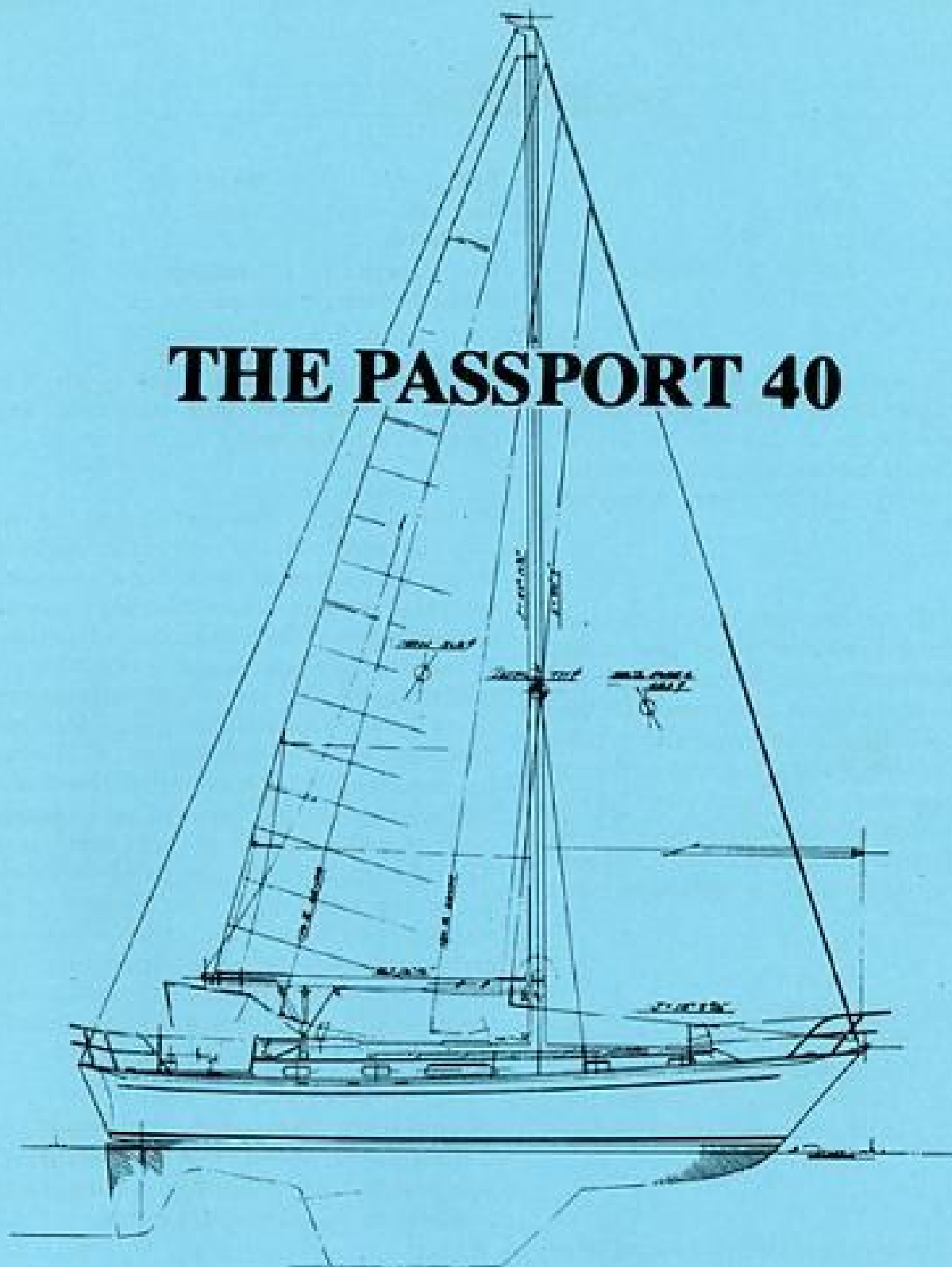

Designed
by
Robert H. Perry



200 Windward Passage • Island Estates
Clearwater, Florida 33515
(813) 446-3590

SPECIFICATIONS

LOA	39' 5"
LWL	33' 5"
Beam	12' 8"
Draft	5' 9" (5' 3" Optional)
Displacement	22,771 lbs.

Ballast	8,500 lbs.
Sail Area	931 sq. ft.
Headroom	6' 2"
Fuel Capacity	125 gallons
Water Capacity	140 gallons

When we set down the general design parameters for yacht designer Robert H. Perry, we wanted a yacht designed for the small liveaboard family, yet one that would have no apologies to make for her sailing ability...and Mr. Perry responded magnificently!

As liveaboards, we constantly analyze the features of a yacht that make it a "home". All yachts involve compromises in one way or another; and so when we set down the arrangement for the Passport 40, we did this using percentages: how much time does one spend in the head compared to the lounging area?...how many times do we cook at sea compared to cooking at anchor or at the dock?...how easy is it to get in and out of bed and to make up the berth?...how often do we have overnight guests?

The results of this approach to interior yacht design are admirably demonstrated in the Passport 40. Although interior modifications are available on a limited basis, we feel that the Passport 40 is a yacht of extreme sailability and live-ability.

The yacht has been designed with the warmth of a teak interior and with an exterior design for ease of maintenance, but still has enough teak trim to make the yacht a beautiful one.

The Passport 40 is built in Taiwan by one of the island's oldest boatbuilding companies: King Dragon Yacht Industrial Co., Ltd.

As with all of our Passport yachts, the construction and detail work of the Passport 40 is under the constant supervision of a representative of our company who resides in Taiwan on a full-time basis and whose exclusive function is to maintain the high standards of quality and craftsmanship that are so well demonstrated in our yachts. Our staff has a combined residency in Taiwan of over 8 years, all of which has been devoted exclusively to the boatbuilding industry and has involved yard management as well as individual yacht supervision. The key to producing quality yachts in Taiwan lies in the selection of boat yards that are responsive to "input" and improvements, together with constant daily supervision. And the quality of the Passport 40 demonstrates the depth of our experience in Taiwan and the concern we take with all of our yachts.

We invite you to inspect the Passport 40 with confidence that you will find it one of the most outstanding and astounding sailing yachts available in the marketplace today.

Distributed by:

Passport Yachts International, Inc., 4th FL, #4, Alley 1,
Lane 220, Sec. 2, Chi Tung Rd., Tien Mou, Taipei, Taiwan
Tel: 02-871-5223

Telex: 28714 MAREAST

STANDARD ARRANGEMENT

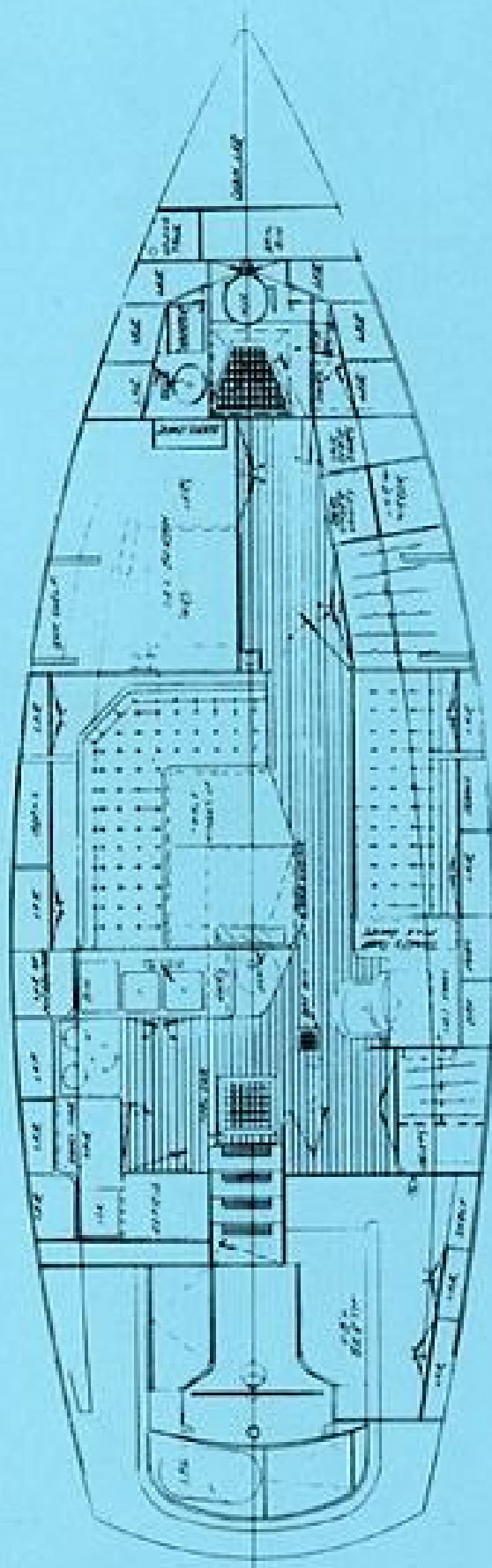

The interior design of the Passport 40 gives a light, airy and open feeling. It's not a yacht that will "close in" on you after you've been aboard her for a time. Upon personal inspection, you will find it hard to believe that such a large living space has been designed into a 40-foot boat!

The galley is large enough for 2 people to move around in with ease. Even the gourmet cook will find ample room for all supplies and accoutrements.

The L-shaped settee features a fold-up table that provides excellent access around the dinette while lounging and entertaining, yet still seats 6 while dining. With this arrangement, the chef is always a part of the conversation and need not leave the galley to pass food to the guests -- or leave the guests to prepare the food. Alternatively, a large U-shaped settee is available if more seating capacity is required.

Those who live aboard recognize the advantage of diesel heat in cold weather; and a centrally located space has been provided for this which is inboard of the galley sinks...where the coffee pot can remain constantly heated. For those who do not require diesel heat, cabinet space can be substituted in the heater area.

The extremely large forward stateroom features a readily accessible double berth that is not a chore to make up and is easy to get into. Opposite the owner's berth are a hanging locker, small chest of drawers with mirror over it and more drawers and lockers. Optionally, a vanity table with a swing-out seat and a large hanging locker is available.

The head and shower are forward in an area not generally well suited for other functions and, again, more than adequate storage space for towels and supplies has been provided.

The starboard sit-down chart table with a swing-out seat is roomy with space for chart stowage and file drawers: a "must" for all liveaboards.

The aft double stateroom provides a perfect berth for guests, or a storage space for all those items that tend to clutter up a yacht. The 30" bi-fold door creates an open look to the stateroom while still providing necessary privacy when needed.

ALL IN ALL, THE PASSPORT 40 HAS ALL THE FEATURES REQUIRED OF A GOOD LIVEABOARD YACHT!

DECK PLAN

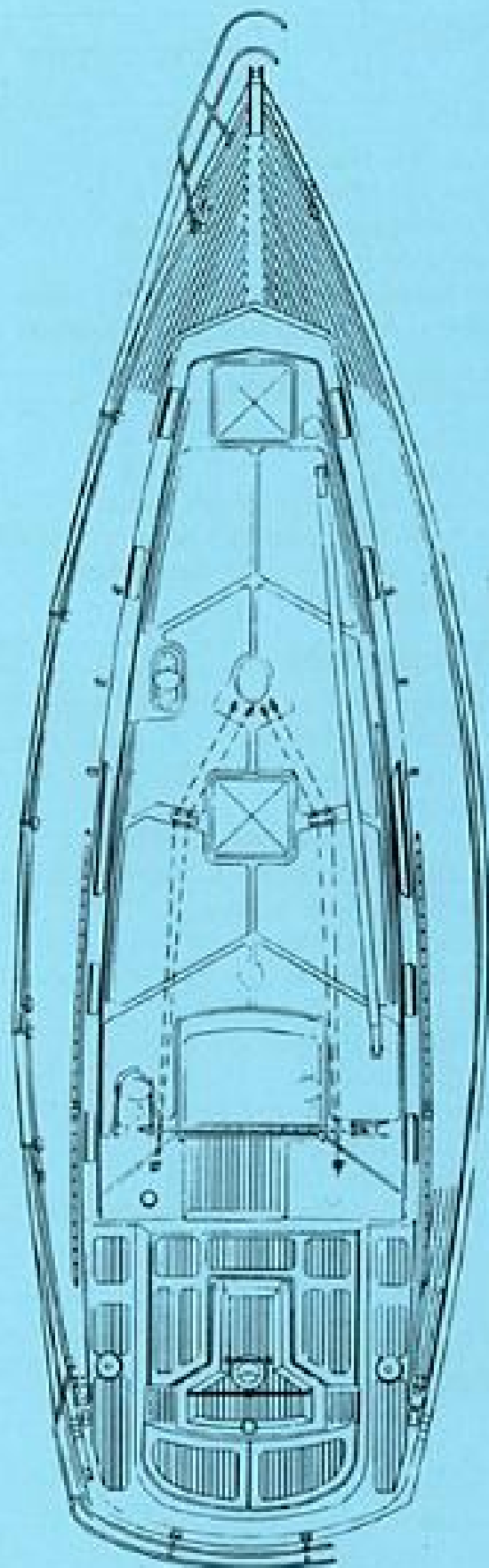

Traditionally, Tiawan yachts have an inordinate amount of exterior teak -- beautiful when the boat is constantly maintained. But we feel good weather should be reserved for sailing, not varnishing! So we have incorporated just enough exterior teak trim which, in combination with the teak decks and cockpit inlays, makes the boat extremely handsome yet not burdensome.

Of primary concern has been the ability to sail the boat essentially from the cockpit. The use of deck organizers and line stoppers with lines lead to the cockpit eliminates the need for extraneous winches, and provides a great flexibility in line handling organization.

The cockpit itself has more than adequate space for stowage, and features contoured cockpit seats and coaming tops with flush inlaid teak and a teak cockpit sole -- all imbedded in Thiakol.

The innovative LPG bottle locker provides space for all valves and controls and is vented directly overboard.

A dodger board lip has been molded into the one-piece deck mold for ease of dodger installation.

A manual bilge pump is mounted to port of the steering wheel.

IN SUMMARY, THE DECK ARRANGEMENT IS CLEAN, FUNCTIONAL, AND COMFORTABLE -- AND SAIL HANDLING IS EASY!

STANDARD EQUIPMENT

ENGINE AND STEERING

Pathfinder 42 HP Diesel
Automatic Bleeding System
Hurth Manual Reduction Gear
Secondary Fuel Filter
U.S. Propeller & Shaft
Insulated Engine Compartment
Instrument Panel at Chart Table
Yacht Specialties Steering System
Pedestal Guard
Throttle & Shifting Controls
Steering Wheel Brake
36" Destroyer Wheel
Emergency Steering Tiller
Flexible Engine Mounts

SPARS AND RIGGING

Aluminum Mast and Boom
Internal Halyards, Prestretched Dacron
1 x 19 SS Standing Rigging
SS Chain Plates and Tangs
Primary Sheet Winches 2 Lewmar 44 ST
Mainsheet & Main Halyard Winch Lewmar 40ST
Genoa Halyard & Reefing Winch Lewmar 40ST
Lock-in Handles 2 10-inch
Dacron Mainsail 9 oz.
130% Genoa, Dacron 6.4 oz.
Mainsail Cover Acrilan
Jib Ready Bag Acrilan

PLUMBING

Hot & Cold Pressure Water System
12V Electric Bilge Pump
Engine - 110V Hot Water Heater
Raritan PH Manual Toilet
Shower Sump Pump
Automatic Electric Bilge Pump
Manual Bilge Pump in Cockpit
Holding Tank
U.S. Single Lever Faucets

GALLEY

Fresh & Salt Water Foot Pumps
3" Foam Insulated Ice Chest
U.S. Deep Double SS Galley Sink
Formica Countertops
Bread Board, Spice Rack, Liquor Locker
Dish Bins, Abundant Drawers & Lockers

ELECTRICAL SYSTEM

110V Ship-to-Shore Connection
110V Outlets
110V & 12V Breaker Switch Panels
2 120 Amp Hour Batteries in Fiberglass Case
AC & DC Volt Meters & Amp Meters
Navigational Lights

DECK HARDWARE

Ten Bronze Opening Ports with Screens
Two Aluminum Hatches
Teak Handrails and Caprails
Mainsheet Traveler
Schaefer Blocks and Deck Hardware
Triple Halyard Stoppers & Deck Organizers
Genoa Tracks with Blocks
Nicro Fico Cowl Vents
Bow & Stern Pulpits
Double Lifelines Gates P & S
Centerline Bow Roller
Cleats & Chocks
Anchor Windlass & 45# Plow Anchor
Teak Decks & Cockpit Sole
Non-Skid Cabin Top
Flush Inlaid Teak Cockpit Seats & Coaming Tops
Built-in LPG Bottle Locker
Seacocks, Bonded

MISCELLANEOUS INTERIOR

APPOINTMENTS

Teak & "Holly" Cabin Sole
Teak Dinette Table
4" Deluxe Fabric-Covered Cushions
5 Coats Hand-Rubbed Varnish

Because we are constantly striving to upgrade our product, specifications and prices are subject to change without notice.